



**Farmingdale
State College**
State University of New York

Friday, March 31st, 2023
Inaugural Symposium

FARMINGDALE STATE COLLEGE

IGNITE
SYMPOSIUM

INAUGURAL
IGNITE
Symposium
Friday, March 31st, 2023

FARMINGDALE STATE COLLEGE
IGNITE SYMPOSIUM

PROGRAM AGENDA

Check-In and Light Refreshment

9:30am—Campus Ballroom Atrium

Welcome Address & Keynote Address

Dr. Laura Joseph, *Senior Vice President and Provost*

Dr. Yetunde Odugbesan, *Acting Director of Community and Civic Engagement*

10:00am—Campus Ballroom A

Poster Session I

10:30am—Campus Ballroom B

SpakrSpeaker Session I

11:30am—Campus Ballroom A

Lunch (provided by Aramark)

12:00pm—Campus Ballroom A

Poster Session II

1:00pm—Campus Ballroom B

SparkSpeaker Session II

2:00pm—Campus Ballroom A

Closing Remarks

Dr. Christopher Malone, *Associate Provost*

2:30pm—Campus Ballroom A

CURATION COMMITTEE

BRYAN GARCIA, Director

Support Services

DYLAN GAFARIAN, Acting Director

Research Aligned Mentorship Program

JENNIFER JAISWAL, Director

Faculty Center

MEGAN MARCHASES, Reference and Instruction Librarian

Greenley Library

DR. YETUNDE ODUGBESAN, Acting Director

Office of Community and Civic Engagement

DONORS & SUPPORTERS

AUXILIARY SERVICE CORPORATION

JEJOBAGELS

7th LENS INC.

KAREN GELLES

MEGAN MARCHASES

CJ EHRlich

JOANNE ULRICH

ARTURO PEREZ

DOUG BOUCHELLE

FSC MARKETING AND COMMUNICATIONS

SARINA TRUBENDIAN

REBECCA HAAS

RITA GROSS

CELESTE DEMBY

DOUGLAS LOPALO

TEVIN FOSTER

FATOMA RAD

PROVOSTS OFFICE

FACULTY EVALUATORS

This event is not possible without the efforts of our volunteer Faculty Evaluators—faculty members and research mentors. The success of the IGNITE Symposium is due in large part to the many evaluators providing feedback to the student presenters throughout the Symposium. In addition to student feedback, the scores are used to award three \$100 Visa Gift Cards! (Faculty Evaluator Rubric, p 14)

DAVID BROCKER, *Applied-Psychology*

DR. MARYBETH APRECIANO, *Applied-Psychology*

LAUREN BAZHDARI, *Business*

DR. MARYA CARTER, *Applied-Psychology*

DR. DEANNA DEVLIN, *Criminal Justice*

APRIL EARL, *Library*

DR. MICKEY FRAINA, *Sports Management*

RITA GROSS, *RAM*

DR. WENAHI LI, *Mechanical Engineering Technology*

KATHY MACHIN, *Library*

DR. CHRISTOPHER MALONE, *Associate Provost*

MEGAN MARCHASES, *Library*

INESA MOTT, *Nexus Center*

DR. YETUNDE ODUGBESAN, *Office of Community and Civic Engagement*

FATOMA RAD, *Library*

RENA VARGHESE, ESQ., *Nexus Center*

DR. SUSAN VOGELL, *Dental Hygiene*

DR. XIAOJIN YE, *Computer Systems*

THERESA ZAHOR, *Library*

KEYNOTE ADDRESS

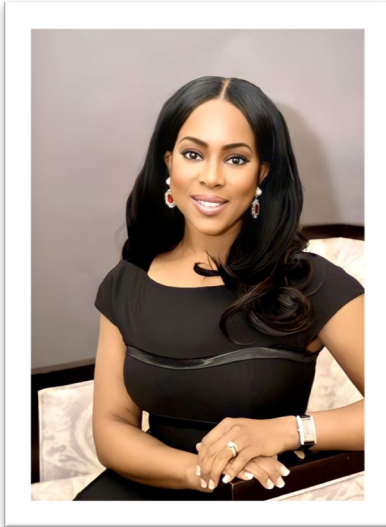

Dr. Yetunde Odugbesan-Omede, Ph.D., is currently the Acting Director of the Office of Community and Civic Engagement and Professor of Global Affairs and Politics at Farmingdale State College (FSC). Dr. Yetunde creates community engagement efforts through a range of activities that promote social action, faculty scholarship and service, student leadership, and developing strategic local and global partnerships. As a faculty member, Dr. Yetunde teaches courses on Comparative Politics, Women in Comparative Political Development, Imperialism, Global Politics, African Politics, American Foreign Policy and others. She is a pracademic who has extensive practitioner and academic based experience in international affairs, public policy and higher education. Yetunde brings a strong track record in leadership, strategic and organizational management, and a progressive approach to international development, democracy building and policy advocacy.

Dr. Yetunde's area of research expertise is in corruption studies, human security and good governance. She was recently awarded a four year tenure as a Fulbright Specialist Scholar in the Fulbright Program under the U.S. Department of State. As a recognition of her contribution and impact in the field of higher education, civic and community engagement and international affairs, Dr. Yetunde was inducted into Rutgers University African-American Hall of Fame Class of 2021. In addition, her work thus far has been inscribed on a paver alongside other impactful alumni at Rutgers University Paul Robeson Plaza, a historic tribute to Rutgers most distinguished alumnus. She is the author of four books that focus on leadership and personal development.

Dr. Yetunde previously worked at United Nations Population Fund, Executive Board and External Relations division, Rutgers University School of Public Affairs and Administration (where was integral in creating the first undergraduate Public Service Major in the country and also the executive EMPA certificate in Executive Management in Public Administration, she also worked in the New Jersey State Ethics Commission, Rutgers Institute for Anti-Corruption Studies amongst others. Dr. Yetunde's interest in global ethics, good governance, human rights, gender equality, and public service has influenced her academic scholarship and professional endeavors. She, received her Doctorate of Philosophy degree in Global Affairs and her Masters of Science in Global Affairs with a concentration in International Law from Rutgers University. She received her Bachelor of Arts in Journalism and Media Studies with a double minor in Africana Studies and Organizational Leadership from Rutgers University as well. She received her certification in U.S. Public Policy: Social, Economic, and Foreign Policies from Harvard University. She also has certificates in international relations, international business, and applied political leadership. She was an Atlantik-Brucke Young Leader, New Leaders Council Fellow, Rutgers Emerging Leaders Scholar, Ronald E. McNair Scholar, Minority Academic Careers Fellow, Eagleton Institute of Politics Fellow and graduate of the United Nations Worldview Institute.

SPARKSPEAKERS SESSION I



Dominique Dulièpre—Project Cirrina

Dominique Dulièpre is currently in his final year of study in the School of Engineering Technology at Farmingdale State College. In May 2023, he will graduate with a Bachelor of Science degree in Electrical Engineering Technology, focusing on autonomous systems and networks. Dulièpre is the founder and president of the National Society of Black Engineers Ram Chapter and is also a member of several professional and student organizations: he is a member of the Institute of Electrical and Electronic Engineers (IEEE), with whom he collaborates regularly on multi-club initiatives; he serves as a board member on the Collegiate Science and Technology Entry Program (C-STEP) advisory board; and he is also a student leader on the Student Affairs and Services Committee (SASC). Throughout the previous semesters, Dominique spearheaded several campus initiatives in collaboration with FSC executive faculty to enhance the college experience for all, including his leadership on the First-Generation College Student Committee. In addition to these major activities, Dulièpre is an electrical engineering emissary representing the EET department. He is also the FSC representative for the 2023 SUNY Norman R. McConney, Jr. award for student excellence. Dominique Dulièpre enjoys building.

Carol Sung—YuanZhuo 圆桌 (Round-Table)

Carol Sung is currently in her 4th year of studying in the School of Visual Arts at Farmingdale State College. In May 2023, she will graduate with an Bachelor of Science in Interaction Design degree, with a focus in UX/UI design and research. Carol was a member of a number of student organizations including the competitive Valorant and League of Legends Esports team, Design Club, and CRU. During the past two years, Carol participated in internships such as a social media marketer and content creator for GENYOUth, a nationally recognized youth wellness organization, and Taste of the NFL, an official NFL-sanctioned event where all proceeds benefit GENYOUth's End Student Hunger fund. She was also a website and dashboard designer for Global Long Island. She also had various achievements such as being one of the winners of the Safe By Design Poster Contest 2020, publishing "Embracing My Culture to #STOPASIANHATE" for Dale News 2021, presenting in the SUNY Undergraduate Research Conference 2021 and 2022, and winning the Long Island Net's Innovation Challenge 2021. As a 4th year senior, she is now serving as a part-time UX/UI and web designer for CivilianCyber and a UX/UI designer for Gapmobile. Recently, she won the SUNY Long Island Pitch Fest 2022 and was chosen as FSC's School of Business's Student Spotlight of Spring 2023. She was also selected as a spotlight on one of FSC's Women's History Month articles. Carol enjoys various activities such as drawing, creating customized art through her small business, and streaming on Twitch. She also likes to practice dancing, karate, and tennis.



Channon Lawrence—Structural Investigation of the Rossman Domain of Corrinoid Iron-Sulfur Protein

Pursuing a bachelor's degree in Nursing alongside a Biology minor, Channon is dedicated to applying scientific thinking to real-world problems confronting individuals, organizations, and industries. As well as utilize medical rationale to help manage the wellness of individuals with chronic illnesses when curating care plans for people from all walks of life. After a few years in the field, she wants to deviate from the traditional nursing clinical path once she graduates and apply her knowledge to research endeavors with a concentration on population health. Channon is recently coming off of a successful mentorship experience at Bernard S. and Sophie G. Gould MIT Summer Research Program, where she studied the carbon fixation process known as the Wood-Ljungdahl pathway (WLP). Prior to that, she was part of Cornell University's Molecular Biology and Genetics (MBG) Summer REU Program in the Life Sciences and studied the Septu anti-phage defense complex in 2021. She is a member of the CSTEP (Collegiate Science and Technology Entry Program) and the RAM (Research Aligned Mentorship) Program, which is also a work-study. When not in the lab or clinical, Channon loves to partake in crafty art projects, spend time with family and friends, and broaden her music appreciation through concerts.



POSTER SESSION I

Poster	Title	Presenters
1	The Effect of Biological Sex of Fat Tissue on Stress Response Activation in <i>Drosophila Melanogaster</i>	John Apollo, Destini Buchanan, Christian Danazar, Karim Niang
2	Quantum Computing and Biology: Examining the Molecules of Life on the Quantum Computer	Imoleayo Abdul
3	First Generation Hispanic College Students and Faculty Mentorship	Kenia Sanchez
4	The Role of DDP-4 cells in Type 2 Diabetes	Gisela Henriquez, Charanjit Singh
5	Green Buildings and their Effect on Greenhouse Gasses in NY	Fatima Shahzad
6	Reducing the Return of Injury After Completing Physical Therapy	Anthony Frank Solimo
7	Climate, Energy, and Environment	Kenneth Grant
8	A Novel Regularization for Higher Accuracy in the Solution of the 3-Dimensional Stokes Flow	Christina Jones
9	Crime Scene in the Classroom: Using Detective Fiction to Teach Forensic Investigations	Daniel Bellucci, Amanda Ruppel
10	Numerical Simulation Of Small-Scale Junction Field Effect Transistors	Dominique Dulièpre
11	Design and Implementation of Electric Door Lock System Using Advanced FPGA Technology	Marco Iorio
12	Modeling a Design-Build Project from Concept to Proposal	Katherine J Bonilla, Gabriela Marisol Carpio, Susan Ehrler, Tahj-Michael Gibbons
13	Making Connections: Evaluating the Effects of Social Media on Teens and Young Adults	Valeria Rodriguez Torres
14	The Effectiveness of Chiropractic Medicine on Synovitis	Edgar Nicholas Feal
15	Impact Hormonal Fluctuation has on Depression	Rewan Eldewak
16	The Presence of Biodiverse Plants on Human Mental Health	Shuana Champagne
17	Progress Towards Structure Solution of a New Titanium Phosphate	Umer Chohan, Kirsten Therese Pangilinan, Susana Pariona, Alex S. Portillo, Saija Villanova
18	Assessment of knowledge and dependency of abusive substances and its prevalence among urban and rural adolescents of Rajkot district, Gujarat State, India	Darshana Nayee
19	The Optimization of Sponge Husbandry	Alice Jenks
20	How Does Social Media Affect Short-Term Memory In Young Adults	Michael Bodrick

POSTER SESSION I

Poster	Title	Participants
21	Lack of Sleep in College Students	Jessica Burgos
22	Prevalence of PTSD in Navy Hospital Corpsman vs. Civilian EMTs	Natalie Jordan
23	The Effects of Commuting to College on College Students' Academics	Kinza Yasmeen
24	An Analysis of Shock Structure in Abell 1763	Joseph Ogden
25	YuanZhuo 圆桌 (Round-Table)	Carol Sung
26	Analyzation and Optimization of the LArASIC P5B Chip Data	Oscar J. Bonilla
27	Practical Quantum Approximate Optimization Algorithm on NISQ Devices	Greg Medwig, Eric Mroczko
28	The Mozart Effect and Spatial Reasoning Performance	Jess Sepe, Julia Wygand
29	Improving Law Enforcement Safety on Traffic Stops	Derek Alek
30	Relationship between MLB team spending and Postseason success	Andrew Prevete
31	"Huntington's Health Heroes" Feeding the Community and Nursing their Well-being	Jennifer Hagen
32	Climatic Stress Decreases Tick-Survival but Increases Host Seeking Behavior	Antonio Pepe
33	Prisoner's Dilemma Game in Watts-Strogatz Network	George Nakashyan
34	The LGBTQ+ Community's Perspective on Police Matters: Exploring Differences in Police Attitudes by Sexual Identity	Elena Ortiz Dilone
35	The Relationship Between Morbid Curiosity, Anxiety, and Voluntary Exposure to Negative Stimuli: An Exploration of Horror Fandom and Clinical Implications	Brendan Jaghab
36	Open Source Software Experiences Amongst FSC Computer Focused Individuals	Rahim Akhter
37	The Effects of Birth Control on Women in New York	Rainely Olivo
38	Internship with the Nassau County District Attorney's Office in Special Victims	Mary Kelly
39	Hacker?	Derek Tol
40	Investigating the role of Ldb1 in establishing dynamic chromatin architecture through the cell cycle	Alma Quijano
41	Tiger Lifespan & Health in Zoos VS Wild	Mishal Syed

POSTER SESSION II

Poster	Title	Participants
1	Forebrain Evolution of Three spine Stickleback fish (<i>Gasterosteus aculeatus</i>) in Recently Transplanted Lake Populations of Cook Inlet, Alaska	Monica Cordova Hernandez
2	Alternative Development Methods for NR9-1500PY Photoresist	Giancarlo Solano
3	UAV Assisted Federated Learning	Tara Minaahang
4	Quantile Estimation with Small Sample Sizes	Matthew DellaRocca, Shaheer Qureshi, Michael Synnott
5	Game-Based Cyber Security Training for Female Adolescents	Faaiza Naeem
6	Undocumented College Students and Their "Sense of Belonging"	Madelyn Del Valle
7	Educational Inequities: Are Non-Profit Funds a Factor ?	Daniela Figueroa
8	Nutritional Impacts	Carolina Apaza
9	Using Video Models to Improve Procedural Fidelity	Katherine Acosta
10	A Filamentous Cyanobacterium from a Desiccated Stream in the Anza Borrego Desert is Identified by Whole Genome Sequencing as <i>Limnoraphis</i> cf. <i>Robusta</i>	Dariana Palacios
11	Do SRO/ Sworn Officers Make Juveniles Feel Safe?	Ana Amaya, Jairo Orozco, Charanjit Singh
12	The Impact of Wealth on Behavior	Jairo Orozco
13	The Single Mother Effect	Elizabeth Ghafoorzada
14	Veterans and PTSD	Gianna Spence
15	Social Media Use and Depression	Gary Xavier
16	How Do Older Adults Feel About Engaging With Cyber-Security	Bradley Roff
17	Structural Investigation of the Rossman Domain of Corrinoid Iron-Sulfur Protein	Channon Lawrence
18	Calibration of a Mobile Device for Accuracy in Crowdsourced Measurements of Urban Noise	Samantha Scavron
19	The Affect Design has on Consumer Recognition	Vito Postiglione
20	College Year vs Procrastination Habits	Mayan Amin

POSTER SESSION II

Poster	Title	Participants
21	Isolating Antibiotic & Potential Marine Pathogen	Shuana Champagnie, Rewan Eldewak, Kayla Menendez
22	The Effects of Memory Retention	Kayla Menendez
23	Comparison of Salary Rates in Bilinguals and Monolinguals in the Hospital Work-place	Christian Intriago
24	Finding a Cure for Childhood Cancer - St. Baldrick's Foundation	John Apollo
25	The Effects of Social Media Influencers on Adolescent Spending	Emily Rustrian-Henriquez
26	New York State Assembly Internship	Khadeeja Maqsood
27	Coupled Solutions to a Discrete Nabla Caputo Fractional Boundary Value Problem	Christina Jones
28	Video Games and Leadership	Jackson Welna
29	Students Perception On Marriage and Divorce	Jiya Singh
30	Cultivating Community Gardens Using Crypto	Esther Joy Sherry
31	Long-Distance Relationships and Academic Success	Keira Kelly
32	Computing the Adjoint Double Layer Potential	Michael Storm
33	Recent Studies on Different Networks Using the Prisoner's Dilemma Game	Piyush Malik, Christian Rodriguez
34	Do Social Media Influencers Affect Rates Of Crime In Teens?	Michelangelo Galluzzo
35	Why Do Juveniles Commit Heinous Crimes?	Sheela Arshad
36	Mental Health and It's Effect on Minorities	Brianna Cesse
37	Mental Health and It's Effect on Minorities	Emely Rodriguez
38	Changing the Altars of the Heart	Kenia Sanchez
39	Teeth Health and Genetic Predisposition	Viktoria Basiou
40	Project Mowjoe	Dominique Dulièpre, Tayyaba Karim, Jennifer Kregel
41	The Influence of Boxing on The Self Confidence of Young Athletes	Jiorvany Adrien
42	The Impact Drill Music has on Culture and Society.	Milan Gayle
43	The Sigma Delta Tau Experience	Autumn Ledbetter

SPARKSPEAKERS SESSION II



Esther Joy Sherry— Cultivating Communities Using Crypto Currency

Esther is a RAM student in her last semester majoring in Interaction Design and Minor in English. She has been a respected partner with several collaborations in the Office of Diversity, Equity, and Inclusive Excellence. She acts as the Chief correspondent for the Dale News and has been the key in optimizing collaboration with other clubs. She is a crusader for environmental sustainability— often found hugging trees or picking up litter— she is an exemplary environmental steward. Even volunteering on the weekends to maintain state parks. She is actively working on a College partnership with Island Harvest Food Bank, a leading hunger-relief organization whose mission is to end hunger and reduce food waste on Long Island with the community garden on campus. She is using her senior project as a vehicle to drive change and make a positive impact on her community and their gardens. Esther is interested in exploring its expansion and the ability to use it to bring attention to food insufficiency which is increasing on Long Island. As an IxD major, Esther clearly understands the character of interactive design and engages the concept of "interaction" in all she does. She is intuitive, consistent, and perceptive. She works multiple jobs to pay her way through college and spends her free time swimming, painting, singing, filming videos, or making delicious meals for her family to enjoy together.

Alice Jenks—The Optimization of Sponge Husbandry

Alice Jenks has been studying with the Bioscience department for 2 years and is currently a senior. She has been fortunate enough to be selected to partake in the Research Alignment Mentorship (RAM) program as well as faculty guided research through the Bioscience department. For the last 2 years, she has been studying microbiology and marine biology under the guidance of multiple faculty members. Through the mentorship from faculty and the RAM program, she has developed her skills as a researcher. Now she is developing her own independent research questions and projects. Alice hopes that the experiences gained at Farmingdale will aid her in her goal to pursue a career in biology research.



Danielle Dockery & Faaiza Naeem—SWiC's Impact

Danielle Dockery is a sophomore here at Farmingdale State College, studying computer programming. She is passionate about bringing the world of technology to underrepresented communities and helping others tap into their potential in this field. She is an active member of several clubs here on campus, all geared towards the same goal.

Faaiza Naeem is currently in her 4th year of study in the School of Engineering at Farmingdale State College. In December 2023, she will graduate with a Bachelor of Science in Computer Security Technology, with a minor in computer forensics. Faaiza is the president of Supporting Women in Computing, the vice president of Muslim Student Association, and a member to Farmingdale's Undergraduate Research club. During the past summer, she was a research assistant for the University of North Texas focusing on Ransomware. In addition to this, Faaiza presented her research proposal at New York City's Women in Computing Conference. In addition to her academics, she is a RAMBassador during the semester sessions and an orientation leader during breaks. A few of her favorite hobbies include travelling, reading and cooking.



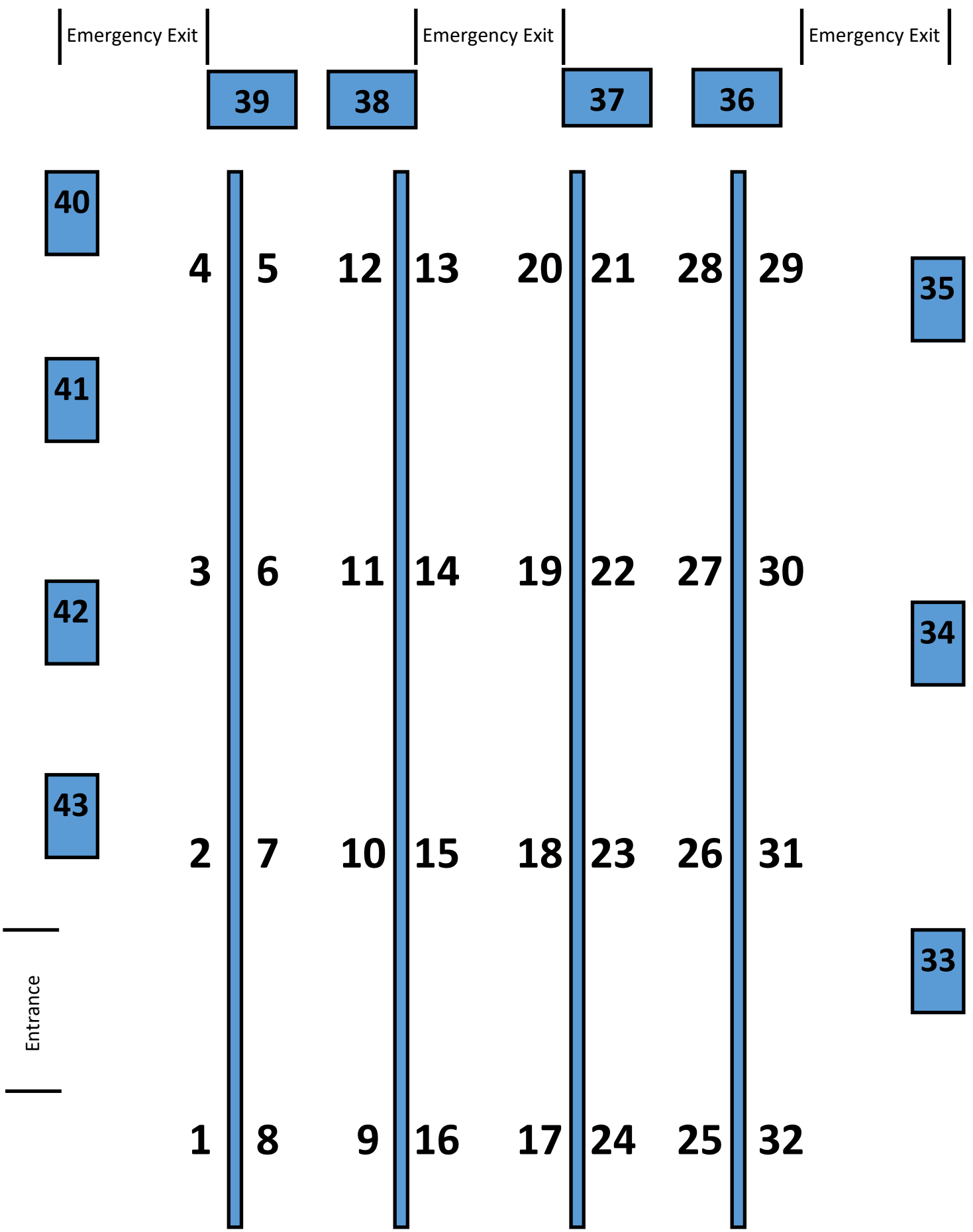



Faculty Evaluation Rubric

Your Name:

Poster Number:

	Points Given			Circle the highest points achieved
	1	2	3	
POSTER CONTENT	<ul style="list-style-type: none"> Introduction/ background information is missing completely or does not include 3 references 	<ul style="list-style-type: none"> Introduction/background information is somewhat clear but lacks a logical connection between each reference 	<ul style="list-style-type: none"> Introduction is clear, 3 references are present, and logical connections are made between each reference 	1 2 3
	<ul style="list-style-type: none"> Hypothesis or objective is inappropriate or missing 	<ul style="list-style-type: none"> Hypothesis or objective is somewhat clear but lacks explanation of relevance to the introduction 	<ul style="list-style-type: none"> Hypothesis is clear, logical, and its relevance is connected back to the introduction 	1 2 3
	<ul style="list-style-type: none"> Methods are missing or incomplete 	<ul style="list-style-type: none"> Methods' justification or detail is limited and there is limited discussion of ethics 	<ul style="list-style-type: none"> Methods are clearly presented, justified, and includes relevant ethical issues 	1 2 3
	<ul style="list-style-type: none"> Anticipated outcome/result and limitations or challenges are missing 	<ul style="list-style-type: none"> Anticipated outcome/result and limitations or challenges are presented but lack clarity and thought 	<ul style="list-style-type: none"> Anticipated outcome/result and limitations or challenges are presented clearly and logically 	1 2 3
	<ul style="list-style-type: none"> Discussion is missing or unrelated to hypothesis/objective and lacks communication about how this would be a novel contribution to the field/real world 	<ul style="list-style-type: none"> Discussion is included, but not well-connected to the hypothesis/objective and/or the novel contribution or real-world relevance is underdeveloped 	<ul style="list-style-type: none"> Discussion supports the literature, is clearly connected to the objective, and clearly explains the novel contribution or real-world relevance 	1 2 3
DIGITAL POSTER AESTHETICS	<ul style="list-style-type: none"> Text is hard to read or messy and contains multiple spelling/grammatical errors Layout is confusing and/or visual aids are inappropriate or missing 	<ul style="list-style-type: none"> Text is relatively clear & legible, but may contain spelling/grammatical errors Layout does not follow logical flow of content and/or photographs, tables, or graphs do not improve understanding 	<ul style="list-style-type: none"> Text is concise, legible and lacks spelling/grammatical errors Photographs, tables, or graphs improve understanding and enhance visual appeal 	1 2 3
OVERALL PRESENTATION	<ul style="list-style-type: none"> Demonstrates no effort put into developing their presentation Does not understand questions or is not receptive to constructive feedback Presentation is very confusing and/or long-winded 	<ul style="list-style-type: none"> Demonstrates some effort in developing the presentation Has some difficulty answering questions or is somewhat dismissive of constructive feedback Presentation is somewhat unclear, rambling, and/or inconsistent 	<ul style="list-style-type: none"> Demonstrates exceptional effort put into developing the presentation Answers questions clearly and succinctly and is receptive to constructive feedback Presentation is consistently clear, logical, and concise 	1 2 3

Comments:

Total: